

ELEVATION

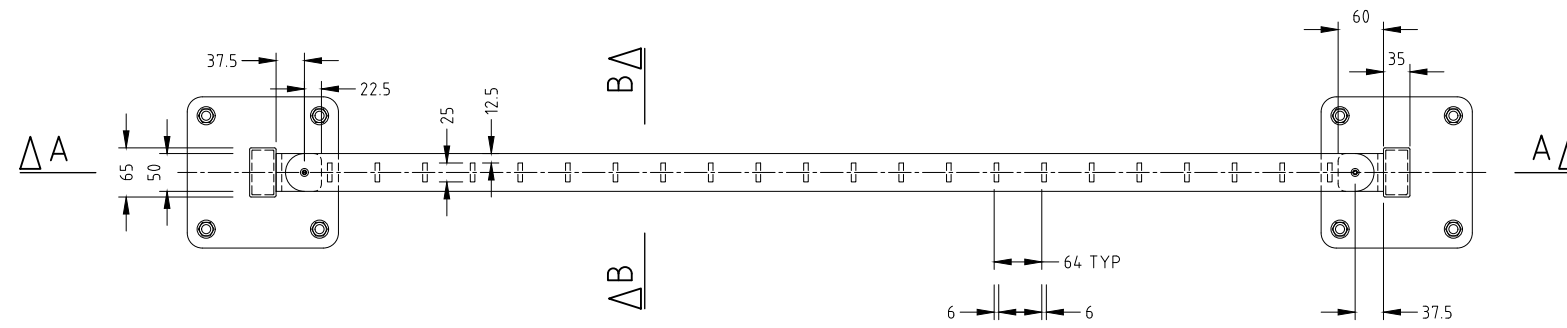

PLAN

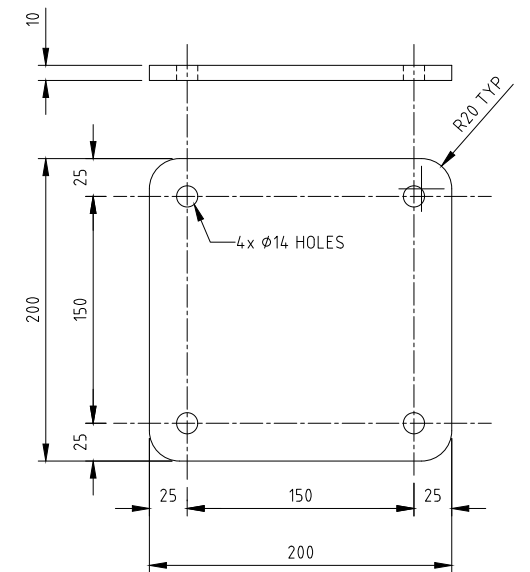

MATERIAL: 200 x 10 M.S. PLATE

BASE PLATE - POST

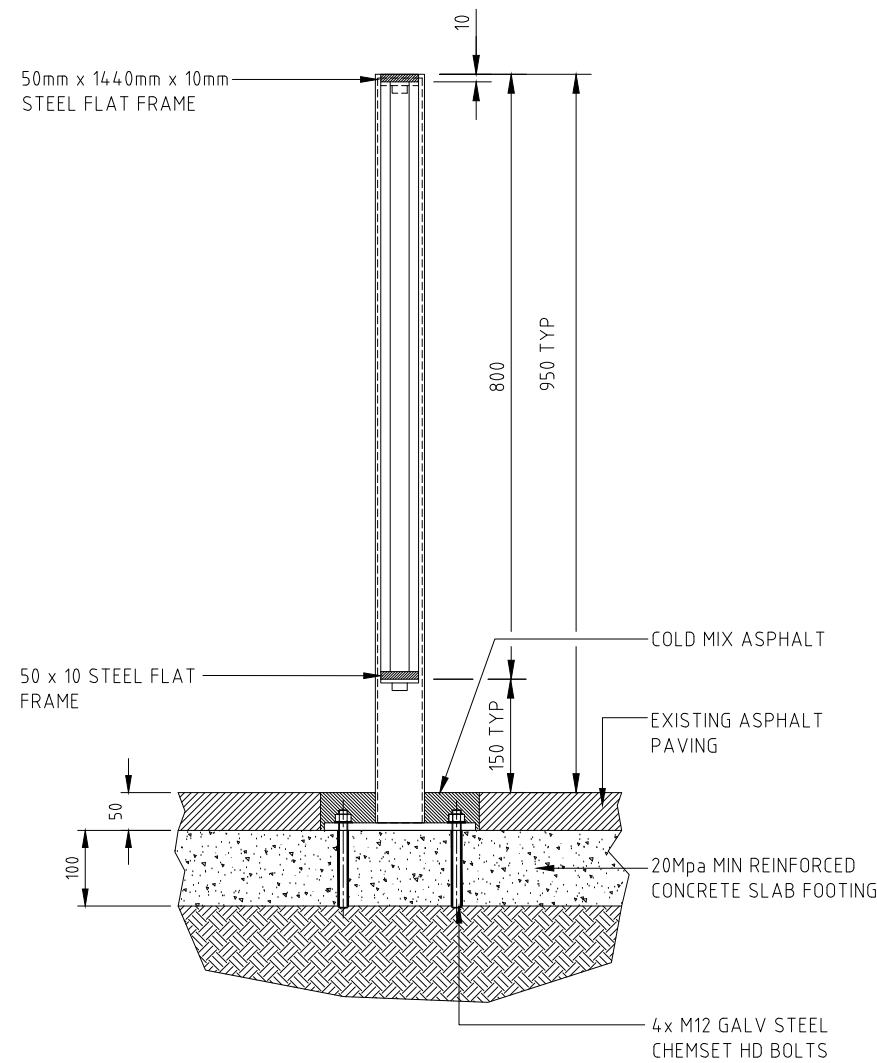

SECTION B-B

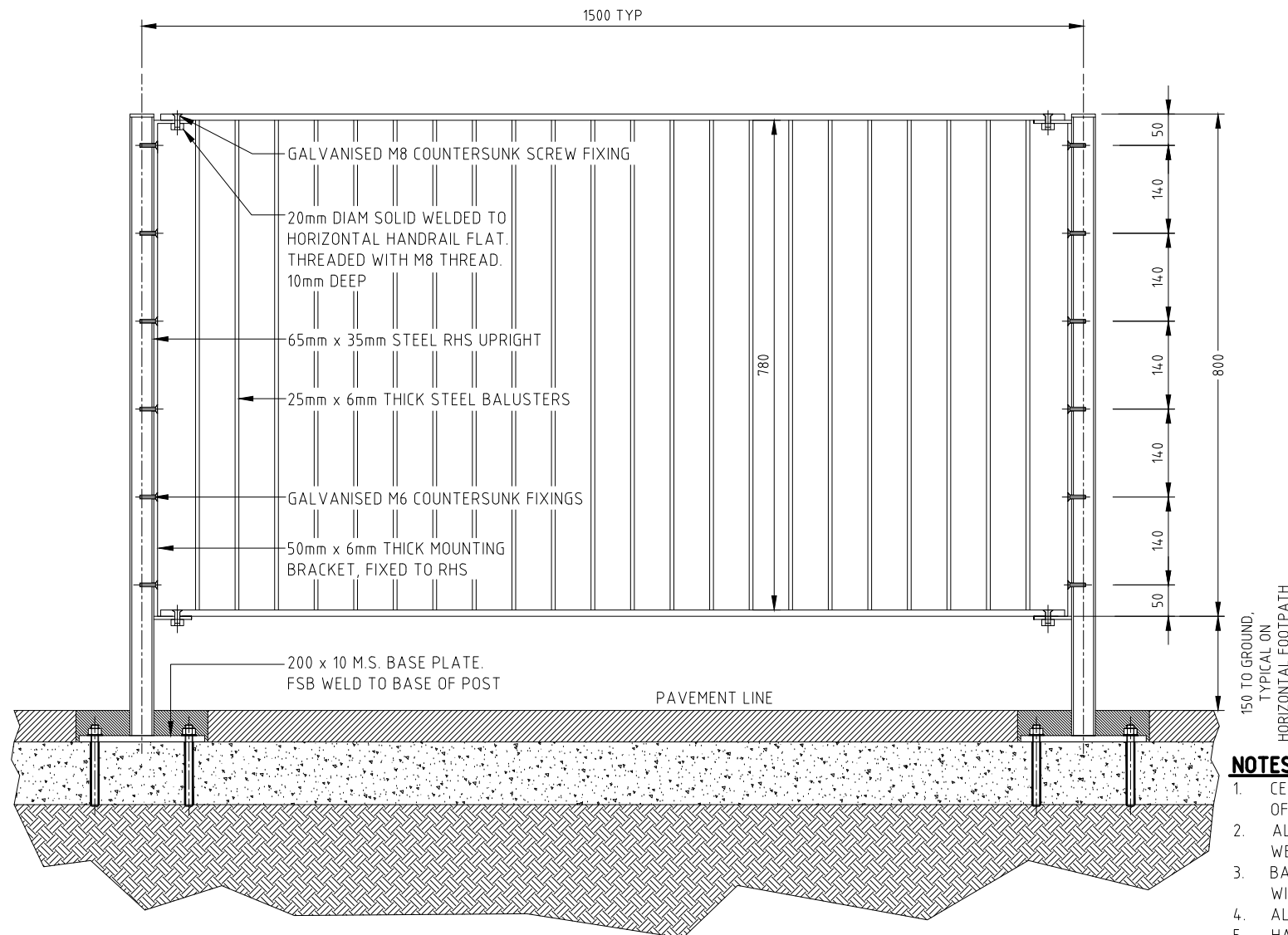

SECTION A-A

NOTES:

- CENTERLINE OF HANDRAIL TO BE 600mm OFFSET FROM THE FACE OF KERB
- ALL SMALL WELDS SHALL BE 4mm CONTINUOUS WITH E41xx WELDING ELECTRODE TO AS 1554 PART 1 & 2 AS APPROPRIATE.
- BARE STEEL AND WELDED AREAS SHALL BE CLEANED COATED WITH ZINCILATE 880 OR EQUIVALENT
- ALL BUTT WELDS SHALL BE FULL PENETRATION
- HANDRAIL AND POSTS SHALL BE ELECTROPLATED IN ACCORDANCE WITH AS1789 AND AS1791(C) STANDARDS PRIOR TO POWDER COATING.
- ONE COAT OF POWDER COAT SHOULD BE APPLIED TO ALL RAILINGS, POSTS AND BALUSTERS. COLOUR SILVER GLO PEARL 84623 (75 MICRONS).

NOT TO SCALE



CITY OF MELBOURNE

Rev.	A	Revision Details	By	Date
				Jun, 20

PEDESTRIAN SAFETY FENCE
(FEDERATION STYLE)
BOLT DOWN

ENGINEERING SERVICES BRANCH

Approved By		Drawing Number	
Principal Engineer Infrastructure		1P 50514C	
Date JUN, 2020		Revision A	
Manager Engineering Services		Docs	
Date JUN, 2020			