

Kerbside protected bike lanes on Grattan Street, Carlton

The City of Melbourne is installing kerbside protected bike lanes on Grattan Street – delivering a safer, better connected cycling network in the heart of Carlton.

The bike lanes will run in both directions from Rathdowne Street to Bouverie Street, and connect to new bike lanes being delivered between Bouverie Street and Royal Parade as part of the Metro Tunnel Project. They will also link to our existing cycling network along Rathdowne Street and Swanston Street.

To support road users travelling along Grattan Street, some traffic management changes will also be introduced to keep people moving - no matter their mode of transport.

The City of Melbourne engaged with the community about the Grattan Street bike lane in 2021 and 2022, and has received approval from the Department of Transport and Planning to deliver this project.

The design plan is included with this letter and provides a summary of the key changes. To find out more, **please scan the QR code below**, call 9658 9658 or visit melbourne.vic.gov.au/cityprojects

What's happening?

- The new bike lanes will be located next to the footpath, protected from traffic by kerbs and parking bays.
- Adjustments will be made to parking along Grattan Street to create space for the project.
- Hook turn movements will be introduced at Cardigan, Lygon and Drummond streets.
- A new bus stop will be added between Bouverie and Swanston streets.
- Road resurfacing between Cardigan and Rathdowne streets.

What you can expect:

- Works are anticipated to start in early 2024 and will take approximately three months to complete.
- Pedestrian, car and bike access on Grattan Street will be maintained at all times while works are underway.
- Work hours will be 7am to 5pm Monday to Friday, with occasional weekend work required.
- Nearby properties will be notified ahead of works commencing.



An example of a kerbside protected bike lane on Rathdowne Street



An example of a kerbside protected bike lane on Swanston Street



Interpreter services

We cater for people of all backgrounds
Please call 03 9280 0726

GRATTAN STREET BIKE LANES

Bouverie Street to Rathdowne Street

Key changes:

- 1.3km of protected bike lanes (650m in each direction) on Grattan Street from Bouverie Street to Rathdowne Street
- Full separation kerbside protected bike lanes (except for a short section where there's a bus stop between Drummond Street and Rathdowne Street on the south side)
- Will connect to new protected bike lanes being delivered between Bouverie Street and Royal Parade as part of the Metro Tunnel Project
- Expands protected bicycle network linking to existing protected bike lanes on Swanston Street and Rathdowne Street
- 68 car parking bays will be retained, with 18 removed (net)
- Reduction in traffic lanes at midblock sections and intersections
- Green surface treatment to highlight bike lane at certain locations
- New vehicle hook turns at selected intersections to provide a safer environment for all road users and support the flow of traffic
- Asphalt resurfacing from Cardigan Street to Rathdowne Street
- New bus stop between Bouverie Street and Swanston Street
- Existing bus stops relocated at Cardigan Street and Lygon Street

Details of treatments for this project



Concrete separator kerb



Separation at intersections



Concrete separator island



Mountable kerb



Road narrowing/painted island



Green surface treatment at selected locations



Flexible bollards

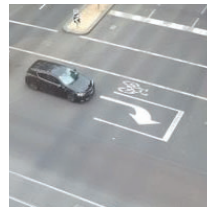

Vehicle hook turn boxes

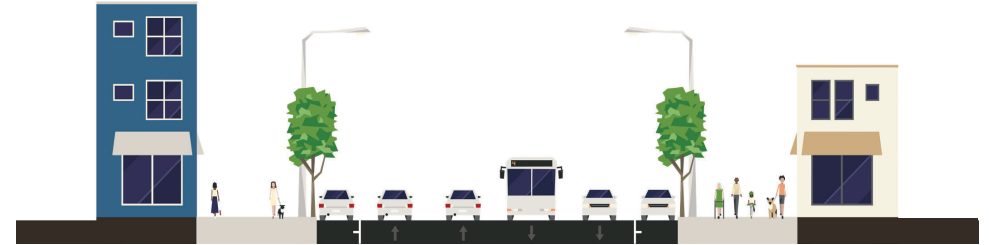

Existing conditions on Grattan Street

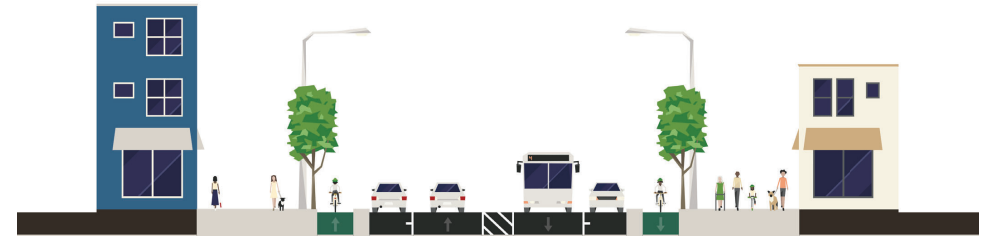

Proposed new conditions on Grattan Street

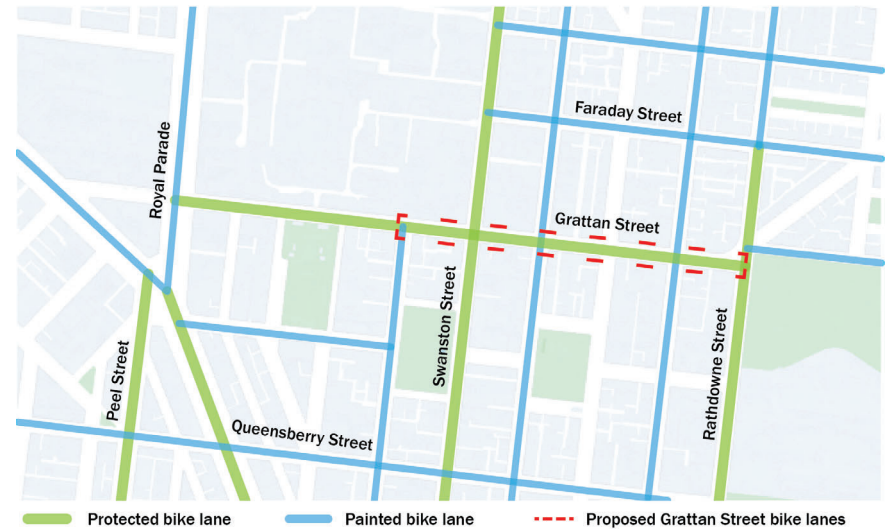

A map of the bike lane network in Carlton

GRATTAN STREET BIKE LANES (1/5)

Section: Bouverie Street to Swanston Street

Key changes:

- Kerbside protected bike lanes
- Parking retained on both sides
- 12 parking bays removed
- Midblock reduction of traffic lanes (both directions)
- Lane reduction on approach to signalised intersections
- New bus stop



Legend:

- Protected bike lane
- Parking bay
- Spike down island
- Spike down kerb
- Green surface treatment
- Bus zone

Will connect to new bike lanes between Bouverie Street and Royal Parade being delivered as part of Metro Tunnel Project

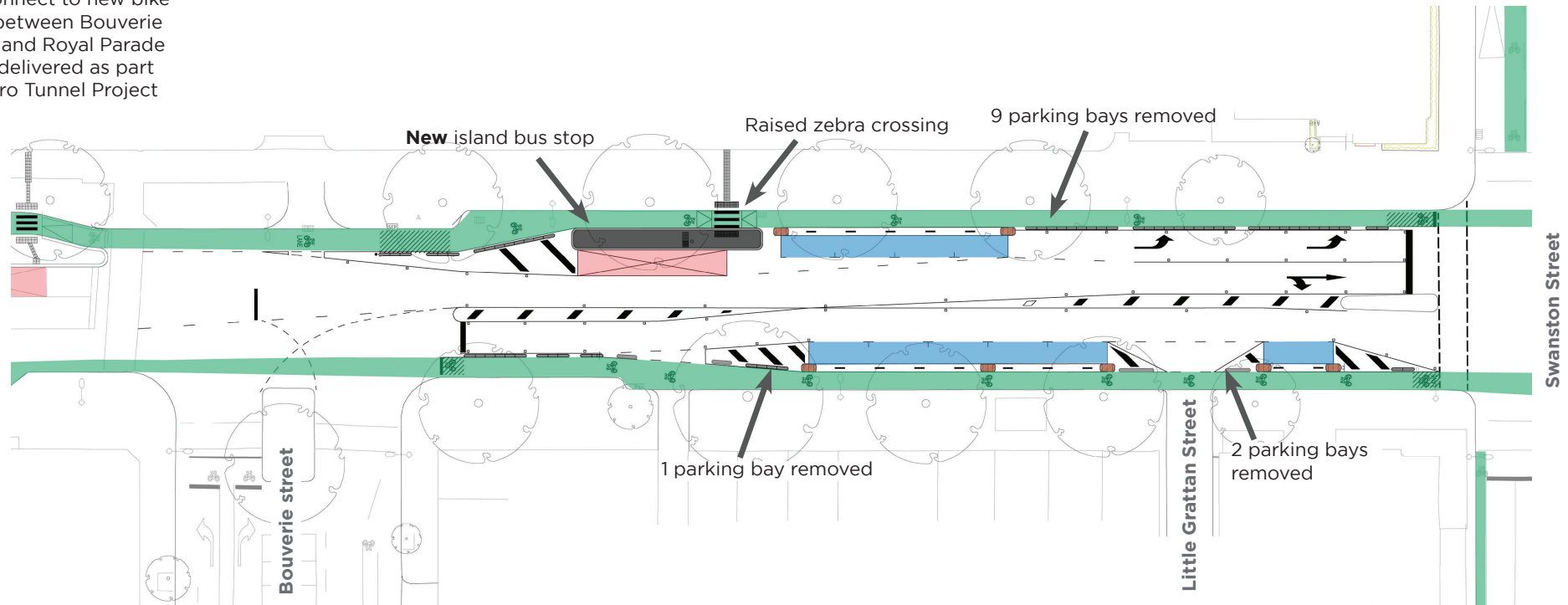

GRATTAN STREET BIKE LANES (2/5)

Section: Swanston Street to Cardigan Street

Key changes:

- Kerbside protected bike lanes
- Parking retained on both sides
- 2 parking bays removed
- Existing eastbound bus stop relocated 60m west
- Midblock reduction of traffic lanes (both directions)
- Lane reduction on approach to signalised intersections
- New hook turns at Cardigan Street
- Asphalt resurfacing in this block



Legend:

- Protected bike lane
- Parking bay
- Concrete separator island
- Concrete separator kerb
- Green surface treatment
- Bus zone

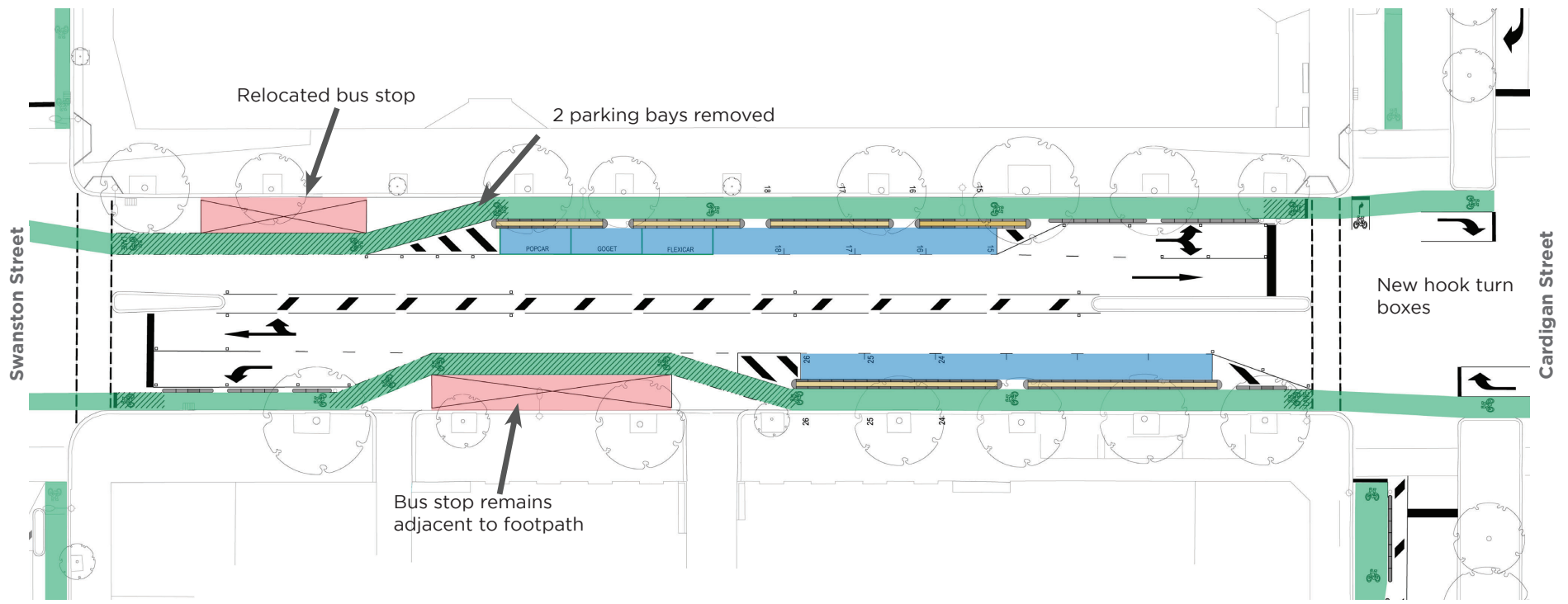

GRATTAN STREET BIKE LANES (3/5)

Section: Cardigan Street to Lygon Street

Key changes:

- Kerbside protected bike lanes
- Parking retained on both sides
- 2 additional parking bays (net)
- Midblock reduction of traffic lanes (both directions)
- Maintains existing lanes on approach to signalised intersections
- Existing eastbound bus stop relocated to east side of Lygon Street intersection
- New hook turns at Lygon Street
- Asphalt resurfacing in this block



Legend:

- Protected bike lane
- Parking bay
- Concrete separator island
- Concrete separator kerb
- Green surface treatment
- Bus zone

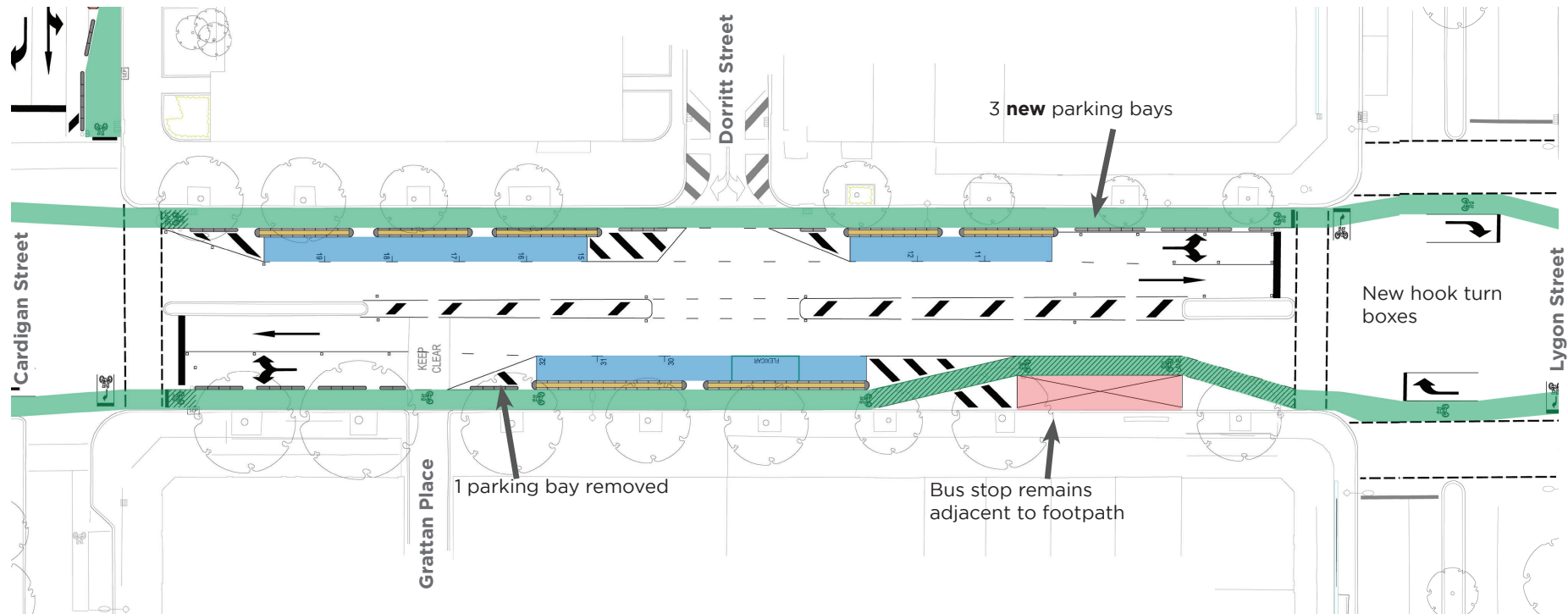

GRATTAN STREET BIKE LANES (4/5)

Section: Lygon Street to Drummond Street

Key changes:

- Kerbside protected bike lanes
- Parking retained on both sides
- 5 parking bays removed
- Midblock reduction of traffic lanes (both directions)
- Lane reduction on approach to signalised intersections
- New hook turns at Drummond Street
- Asphalt resurfacing in this block



Legend:

- Protected bike lane
- Parking bay
- Concrete separator island
- Concrete separator kerb
- Green surface treatment
- Bus zone

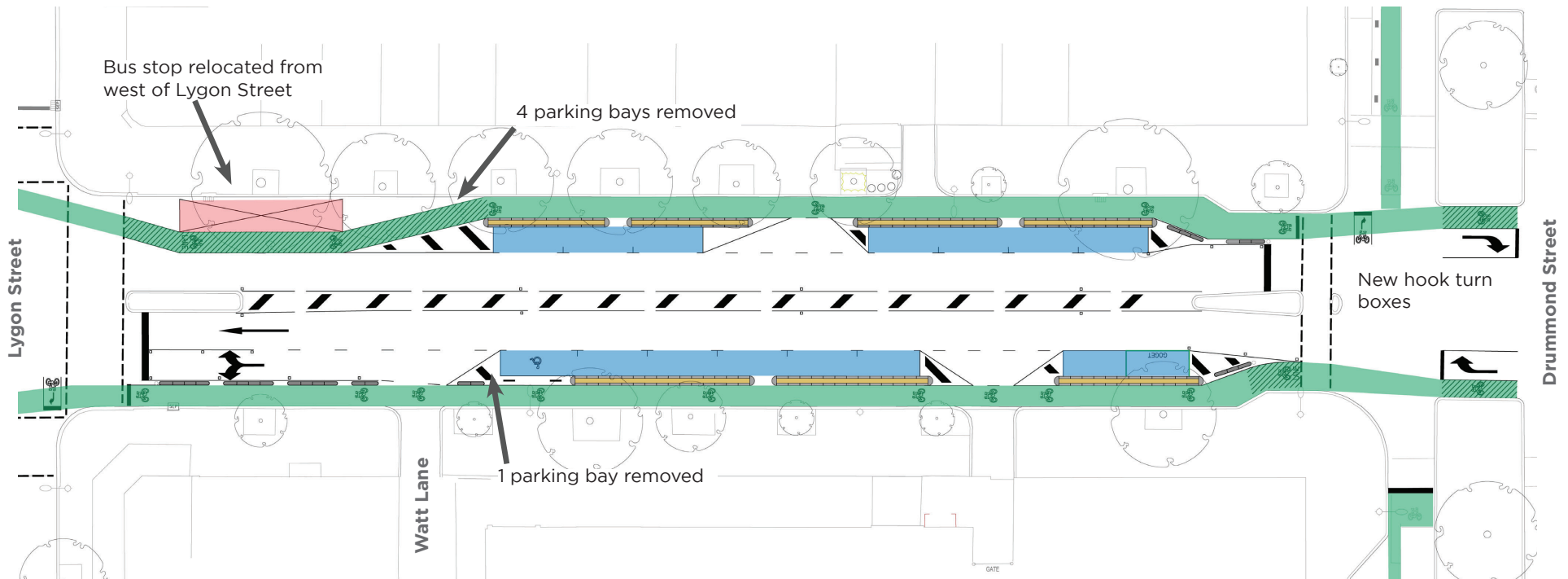

GRATTAN STREET BIKE LANES (5/5)





Section: Drummond Street to Rathdowne Street

Key changes:

- Kerbside protected bike lane (eastbound)
- Bike lane with painted buffer (westbound)
- Parking retained on both sides
- 1 parking bay removed
- Midblock reduction of traffic lanes (both directions)
- Lane reduction on approach to signalised intersections
- Asphalt resurfacing in this block



Legend:

- Bike lane 
- Parking bay 
- Concrete separator island 
- Concrete separator kerb 
- Green surface treatment 
- Bus zone 